

Tav. 16 BOCCOLE FUSELLO • STUB AXLE'S BUSHES

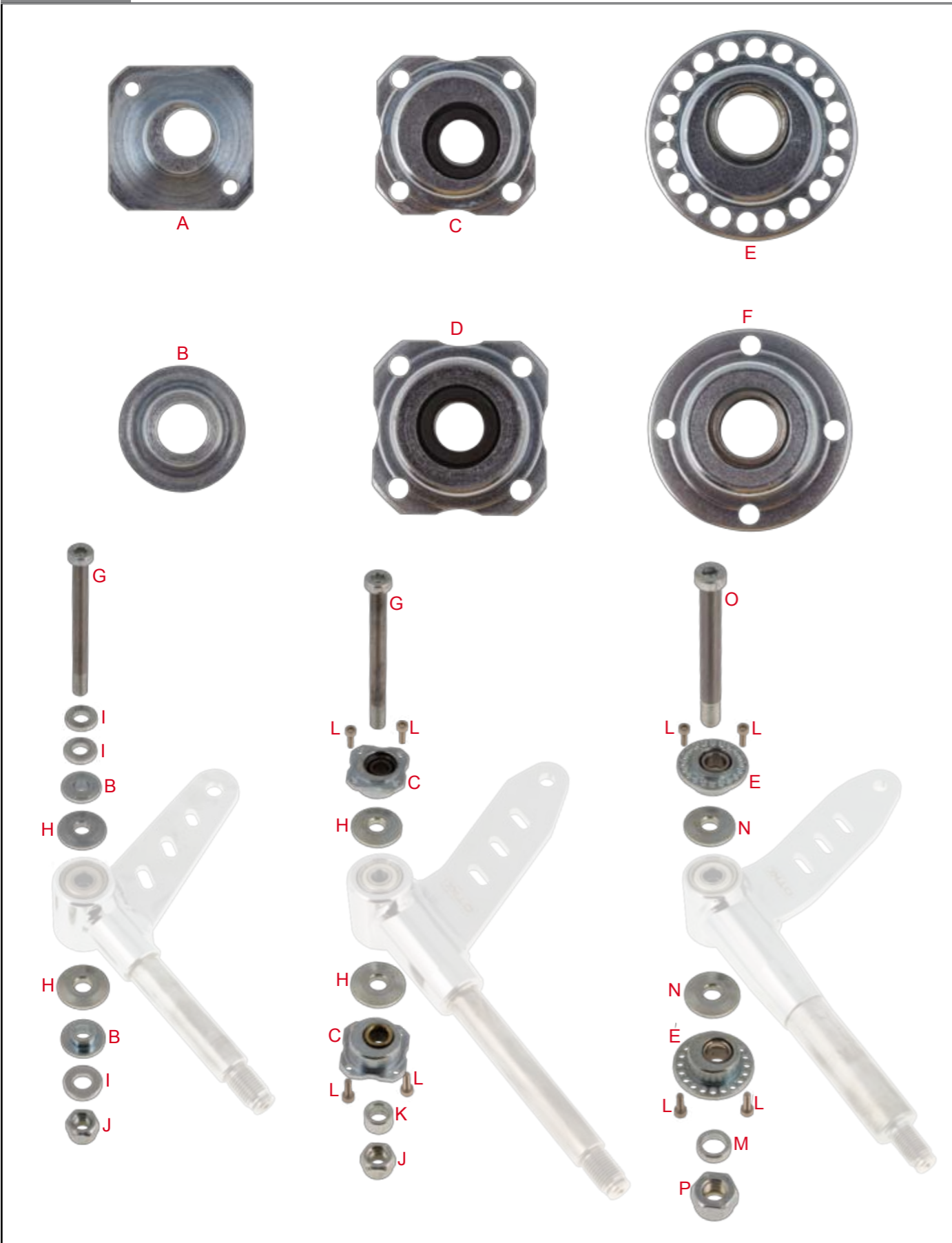

Tav.	Rif.	Cod.	Descrizione	Description	N°
		OF101015E	BOCCOLE FUSELLO	STUB AXLE'S BUSHES	
16	A	0211.00	Boccola eccentrica Ø 12 mm	Eccentric bush Ø 12 mm	
16	B	0212.00	Boccola Ø 12 mm	Bush Ø 12 mm	
16	C	0211.AOKIT	Boccola eccentrica Ø 22 - 8 mm completa	Complete eccentric bush Ø 22 - 8 mm	
16	D	0212.AOKIT	Boccola Ø 22 - 8 mm completa	Complete bush Ø 22 - 8 mm	
16	E	0211.DOKIT	Boccola eccentrica HST Ø 22 - 10 mm completa	Complete HST eccentric bush Ø 22 - 10 mm	
16	F	0212.DOKIT	Boccola HST Ø 22 - 10 mm completa	Complete HST bush Ø 22 - 10 mm	
16	G	0018.A0	Vite fusello BST 8 x 90	BST stub axle's screw 8 x 90	
16	G	0018.A0F	Vite fusello BST 8 x 90 forata	Drilled BST stub axle's screw 8 x 90	
16		0255.00	Molletta viti forate	Spring for drilled screws	
16	H	0215.00	Distanziale fusello BST Ø 8 x 24 x 4 mm	BST stub axle's spacer Ø 8 x 24 x 4 mm	
16	I	R.P.8X17X3	Distanziale fusello BST Ø 8 x 17 x 3 mm	BST stub axle's spacer Ø 8 x 17 x 3 mm	10 pcs
16	J	D.M8A.A.	Dado M8 A.A.	A.A. nut M8	10 pcs
16	K	0211.A4	Rondella Ø 8 x 7 mm per boccola Ø 22 - 8 mm	Washer Ø 8 x 7 mm for bush Ø 22 - 8	
16	L	V.TCEX3X10	Vite TCEI 3 x 10 inox	Inox TCEI screw 3 x 10	10 pcs
16	M	0211.D4	Rondella Ø 10 x 4,5 mm per boccola HST Ø 22 - 10 mm	Washer Ø 10 x 4,5 mm for HST bush Ø 22 - 10 mm	
16	N	0215.CA	Distanziale fusello HST Ø 10 x 24 x 4 mm	HST stub axle's spacer Ø 10 x 24 x 4 mm	
16	O	0018.C0	Vite fusello HST 10 x 90	HST stub axle's screw 10 x 90	
16	O	0018.C0F	Vite fusello HST 10 x 90 forata	Drilled HST stub axle's screw 10 x 90	
16	P	D.M10A.A.	Dado M10 A.A.	A.A. nut M10	10 pcs